

Alfa Laval

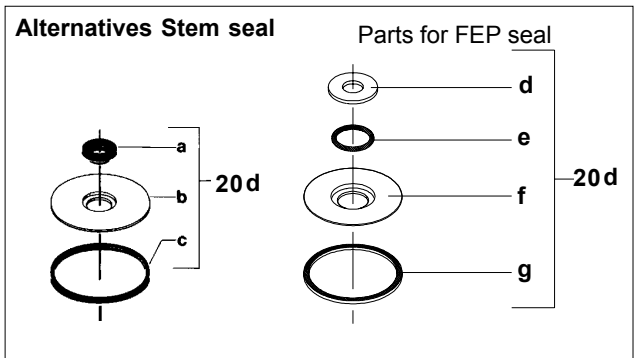
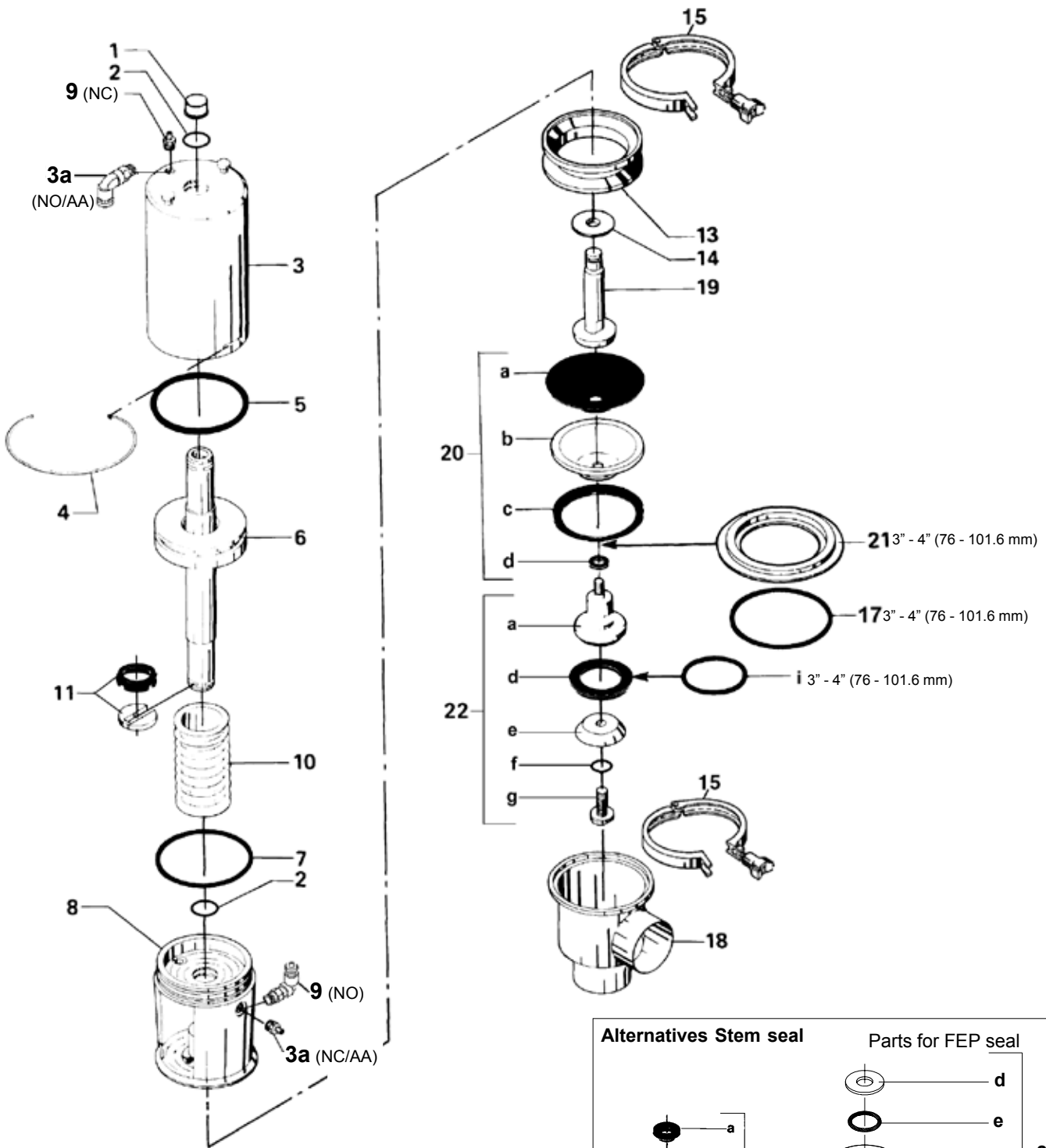

Asceptic Remote Controlled Valve ARC Shut-off Valve

Actuator

Pos.	Qty.	Description	1.5" Part No.	2" Part No.	2.5" Part No.	3" Part No.	4" Part No.
	1	Complete actuator-10 (NO) industrial	3135302061	3135302061	3135302061	3135302141	3135302141
	1	Complete actuator-20 (NC) industrial	3135302062	3135302062	3135302062	3135302142	3135302142
	1	Complete actuator-30 (A/A) industrial	3135302063	3135302063	3135302063	3135302143	3135302143
	1	Complete actuator-10 (NO) polished	3135310011	3135310011	3135310011	3135310021	3135310021
	1	Complete actuator-20 (NC) polished	3135310012	3135310012	3135310012	3135310022	3135310022
	1	Complete actuator-30 (A/A) polished	3135310013	3135310013	3135310013	3135310023	3135310023
1	1	Cap	31801-0525-6	31801-0525-6	31801-0525-6	31801-0525-5	31801-0525-5
2Δ	2	O-ring	223406-25	223406-25	223406-25	223406-49	223406-49
3	1	Cylinder	31353-0139-1	31353-0139-1	31353-0139-1	31353-0185-1	31353-0185-1
3 a	1	Air Fitting (NO)	881-249420	881-249420	881-249420	881-249420	881-249420
	1	Air Fitting (NC)	881-249420	881-249420	881-249420	881-249420	881-249420
	2	Air Fitting (A/A)	881-249420	881-249420	881-249420	881-249420	881-249420
4Δ	1	Lock wire	31353-0151-1	31353-0151-1	31353-0151-1	31353-0189-1	31353-0189-1
5Δ	1	O-ring	223401-74	223401-74	223401-74	223401-75	223401-75
6	1	Piston -1, -2	31353-0621-1	31353-0621-1	31353-0621-1	31353-0619-1	31353-0619-1
	1	Piston -3	31353-0621-2	31353-0621-2	31353-0621-2	31353-0619-2	31353-0619-2
7Δ	1	O-ring	223406-67	223406-67	223406-67	223406-17	223406-17
8	1	Bonnet	31353-0133-2	31353-0133-2	31353-0133-2	31353-0190-2	31353-0190-2
9*	1	Exhaust plug (NO)	31353-0154-1	31353-0154-1	31353-0154-1	31353-0154-1	31353-0154-1
	1	Exhaust plug (NC)	31353-0154-1	31353-0154-1	31353-0154-1	31353-0154-1	31353-0154-1
10*	1	Spring assembly (standard black).....	31353-0625-1	31353-0625-1	31353-0625-1	31353-0622-1	31353-0622-1
	1	Spring assembly with extra strong spring (white)	31353-0625-2	31353-0625-2	31353-0625-2	31353-0622-2	31353-0622-2
11Δ	1	Clip, complete	31353-0793-1	31353-0793-1	31353-0793-1	31353-0793-2	31353-0793-2
Δ	1	Service kit for actuator	9611-92-0008	9611-92-0008	9611-92-0008	9611-92-0009	9611-92-0009

* Only for actuators -10 and -20.

Parts marked with Δ are included in the actuator service kit.

Valve Parts

13	1	Intermediate piece	31353-0813-1	31353-0813-1	31353-0813-1	31353-0840-1	31353-0840-1
Clamp							
15	1	Heavy duty clamp	9612-0112-04	9612-0112-04	9612-0112-04	9612-0112-05	9612-0112-05
15a	1	Heavy duty clamp	884-28969	884-28969	884-28969	9612-0112-05	9612-0112-05
Valve body (industrial)							
18	1	Valve body, lower, 2 ports, GC	31353-0029-70	31353-0030-7	31353-0031-7	31353-0032-7	31353-0066-7
	1	Valve body, lower, 2 ports, weld	31353-0375-1	31353-0376-1	31353-0380-1	31353-0381-1	31353-0026-1
	1	Valve body, lower, 3 ports, GC	884-253260	884-25327	31353-0039-7	31353-0040-7	884-26875
	1	Valve body, lower, 3 ports, weld	31353-0375-6	31353-0376-6	31353-0380-6	31353-0381-6	31353-0026-6
Valve body (polished)							
18	1	Valve body, lower, 2 ports, GC	31353-1030-10	31353-1030-2	31353-1030-3	31353-1030-4	31353-1030-5
	1	Valve body, lower, 2 ports, weld	31353-1100-1	31353-1101-1	31353-1102-1	31353-1103-1	31353-1104-1
	1	Valve body, lower, 3 ports, GC	31353-1031-10	31353-1031-2	31353-1031-3	31353-1031-4	31353-1031-5
	1	Valve body, lower, 3 ports, weld	31353-1100-2	31353-1101-2	31353-1102-2	31353-1103-2	31353-1104-2
Valve Plug							
14	1	Washer (prior to 11/99)	31353-0821-1	31353-0821-1	31353-0821-1	31353-0821-2	31353-0821-2
14	1	Washer (post 11/99 to present)	31353-0821-3	31353-0821-3	31353-0821-3	31353-0821-3	31353-0821-3
17Δ	1	Seal ring, EPDM (standard)	N/A	N/A	N/A	31353-0205-1	31353-0205-1
	1	Seal ring, NBR	N/A	N/A	N/A	31353-0205-2	31353-0205-2
	1	Seal ring, FPM	N/A	N/A	N/A	31353-0205-3	31353-0205-3
19	1	Stem, upper	31353-0809-1	31353-0809-1	31353-0809-1	31353-0839-1	31353-0839-1
20Δ	1	Diaphragm set, PTFE, EPDM	9611-92-0001	9611-92-0001	9611-92-0001	9611-92-0007	9611-92-0007
		(complete replacement recommended)					
	1	Diaphragm set, NBR	9611-92-0081	9611-92-0081	9611-92-0081	9611-92-0083	9611-92-0083
	1	Diaphragm set, FPM	9611-92-0082	9611-92-0082	9611-92-0082	9611-92-0084	9611-92-0084
20 a	1	Diaphragm support, EPDM	31353-0816-1	31353-0816-1	31353-0816-1	31353-0816-2	31353-0816-2
20 b	1	Diaphragm, PTFE	31353-0820-1	31353-0820-1	31353-0820-1	31353-0820-2	31353-0820-2
20 c	1	L-seal, EPDM (standard)	31353-0817-1	31353-0817-1	31353-0817-1	31353-0817-1	31353-0817-1
	1	L-seal, NBR	31353-0817-2	31353-0817-2	31353-0817-2	31353-0817-2	31353-0817-2
	1	L-seal, FPM	31353-0817-3	31353-0817-3	31353-0817-3	31353-0817-3	31353-0817-3
20 d	1	Stem seal, EPDM (standard)	31353-0818-1	31353-0818-1	31353-0818-1	31353-0818-2	31353-0818-2
	1	Stem seal, NBR	31353-0818-3	31353-0818-3	31353-0818-3	31353-0818-4	31353-0818-4
	1	Stem seal, FPM	31353-0818-5	31353-0818-5	31353-0818-5	31353-0818-6	31353-0818-6



CSI

CONTACT CSI FOR MORE INFORMATION | CSIDESIGNS.COM | SALES@CSIDESIGNS.COM | 417.831.1411

Valve Parts (continued)

Pos.	Qty.	Description	1.5" Part No.	2" Part No.	2.5" Part No.	3" Part No.	4" Part No.
Valve Plug							
21	1	Diaphragm ring	N/A	N/A	N/A	31353-0841-1	31353-0841-1
22	1	Plug, single, complete, EPDM (standard)	31353-0823-1	31353-0823-2	31353-0823-3	31353-0848-1	31353-0848-2
		Plug, single, complete, NBR	9612-3094-01	9612-3094-02	9612-3094-03	9612-3092-01	9612-3092-02
		Plug, single, complete, FPM	9612-3094-07	9612-3094-08	9612-3094-09	9612-3092-06	9612-3092-07
a	1	Stem, lower	31353-0811-1	31353-0812-1	31353-0815-1	31353-0843-1	31353-0846-1
dΔ	1	Seal, EPDM (standard)	31353-0320-1	31353-0321-1	31353-0322-1	N/A	N/A
	1	Seal, NBR	31353-0320-2	31353-0321-2	31353-0322-2	N/A	N/A
	1	Seal, FPM	31353-0320-3	31353-0321-3	31353-0322-3	N/A	N/A
e	1	Washer	31353-1010-1	31353-1010-2	31353-0359-1	31353-0845-1	31353-0845-2
fΔ	1	O-ring, EPDM (standard)	990034-01	990034-01	990034-01	990034-01	990034-01
	1	O-ring, NBR	223404-21	223404-21	223404-21	223404-21	223404-21
	1	O-ring, FPM	223404-35	223404-35	223404-35	223404-35	223404-35
g	1	Screw	31353-1011-1	31353-1011-1	31353-1011-1	31353-1011-1	31353-1011-1
iΔ	1	O-ring, EPDM (standard)	N/A	N/A	N/A	9611-99-0544	9611-99-1491
	1	O-ring, NBR	N/A	N/A	N/A	9611-99-0029	9611-99-2549
	1	O-ring, FPM	N/A	N/A	N/A	9611-99-1345	9611-99-2550
Δ	1	Service kit for valve, EPDM	9611-92-0040	9611-92-0041	9611-92-0042	9611-92-0043	9611-92-0044
Δ	1	Service kit for valve, NBR	9611-92-0085	9611-92-0087	9611-92-0089	9611-92-0091	9611-92-0093
Δ	1	Service kit for valve, FPM	9611-92-0086	9611-92-0088	9611-92-0090	9611-92-0092	9611-92-0094

Parts marked with Δ are included in the valve service kits.

Alternatives

Stem seal							
20d	1	Lip seal kit, EPDM (standard)	9611-92-0078	9611-92-0078	9611-92-0078	9611-92-0142	9611-92-0142
	1	Lip seal kit, NBR	9611-92-0079	9611-92-0079	9611-92-0079	9611-92-0143	9611-92-0143
	1	Lip seal kit, FPM	9611-92-0080	9611-92-0080	9611-92-0080	9611-92-0144	9611-92-0144
a●	1	Lip seal, EPDM	9612-2806-01	9612-2806-01	9612-2806-01	9612-3088-01	9612-3088-01
	1	Lip seal, NBR	9612-2806-02	9612-2806-02	9612-2806-02	9612-3088-02	9612-3088-02
	1	Lip seal, FPM	9612-2806-03	9612-2806-03	9612-2806-03	9612-3088-03	9612-3088-03
b	1	Plate	9612-2805-01	9612-2805-01	9612-2805-01	9612-3087-01	9612-3087-01
c●	1	Seal ring, EPDM	31353-0128-1	31353-0128-1	31353-0128-1	31353-0205-1	31353-0205-1
	1	Seal ring, NBR	31353-0128-2	31353-0128-2	31353-0128-2	31353-0205-2	31353-0205-2
	1	Seal ring, FPM	31353-0128-3	31353-0128-3	31353-0128-3	31353-0205-3	31353-0205-3
Stem seal							
20dd	1	Washer	31353-0452-1	31353-0452-1	31353-0452-1	31353-0452-2	31353-0452-2
e●	1	O-ring FEP/Silicone	9611-99-2909	9611-99-2909	9611-99-2909	9611-99-2910	9611-99-2910
f	1	Holder	31353-0453-1	31353-0453-1	31353-0453-1	31353-0454-1	31353-0454-1
g●	1	Valve body packing	31353-0451-1	31353-0451-1	31353-0451-1	31353-0451-2	31353-0451-2
●		Service kit EPDM	9611-92-0471	9611-92-0475	9611-92-0479	9611-92-0483	9611-92-0491
●		Service kit NBR	9611-92-0472	9611-92-0476	9611-92-0480	9611-92-0484	9611-92-0492
●		Service kit FPM	9611-92-0473	9611-92-0477	9611-92-0481	9611-92-0485	9611-92-0493
●		Service kit FEP	9611-92-0474	9611-92-0478	9611-92-0482	9611-92-0486	9611-92-0494

Parts marked with ● are included in the special lip seal service kits.

1	Rebuilding set EPDM, SRC-A to ARC	31353-0833-1	31353-0833-2	31353-0833-3	31353-0836-1	31353-0836-2
	(The rebuilding set contains Pos. 13, 15, 19, 20, 22a, 22b, 22d, 22f)					

Valve Body Combinations:



Recommended Spare Parts: Service kit

