

Alfa Laval

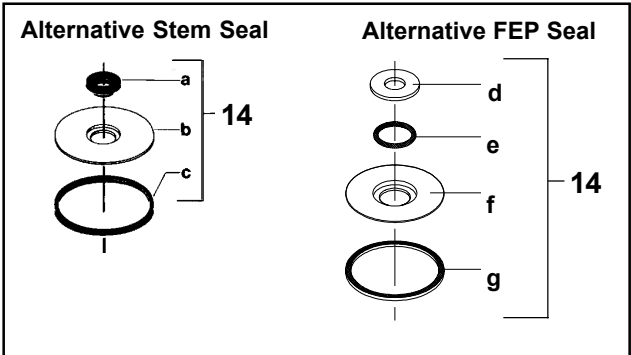
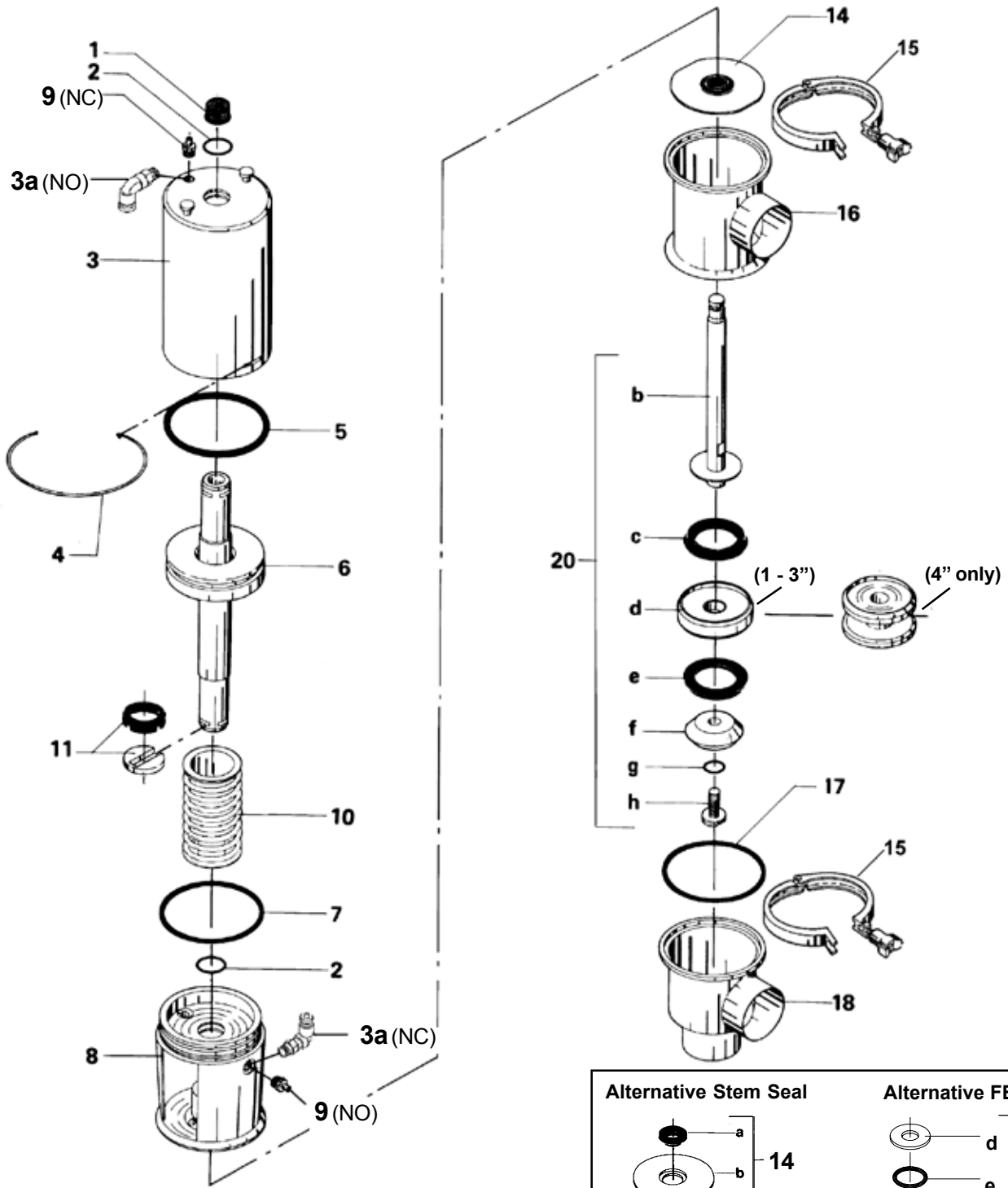

Sanitary Remote Controlled Valve SRC-LS Divert Valve

Actuator

Pos.	Qty.	Description	2-inch Part No.	2.5-inch Part No.	3-inch Part No.	4-inch Part No.
	1	Complete actuator-10 (NO) industrial	9612-1260-02	9612-1261-02	9612-1262-02	9612-1262-02
	1	Complete actuator-20 (NC) industrial	9612-1260-04	9612-1261-04	9612-1262-04	9612-1262-04
	1	Complete actuator-10 (NO) polished	9612-1260-01	9612-1261-01	9612-1262-01	9612-1262-01
	1	Complete actuator-20 (NC) polished	9612-1260-03	9612-1261-03	9612-1262-03	9612-1262-03
1	1	Cap	31801-0525-6	31801-0525-5	31801-0525-5	31801-0525-5
2Δ	2	O-ring	223406-25	223406-49	223406-49	223406-49
3	1	Cylinder	9612-1219-02	9612-1225-02	9612-1225-02	9612-1225-02
3a	1	Air fitting (NO)	881249420	881249420	881249420	881249420
	1	Air fitting (NC)	881249420	881249420	881249420	881249420
4Δ	1	Lock wire	31353-0151-1	31353-0189-1	31353-0189-1	31353-0189-1
5Δ	1	O-ring	223401-74	223401-75	223401-75	223401-75
6	1	Piston	9612-1239-01	9612-1230-01	9612-1230-01	9612-1230-01
7Δ	1	O-ring	223406-67	223406-17	223406-17	223406-17
8	1	Bonnet	9612-1238-02	9612-1237-02	9612-1221-02	9612-1221-02
9	1	Exhaust plug (NO)	31353-0154-1	31353-0154-1	31353-0154-1	31353-0154-1
	1	Exhaust plug (NC)	31353-0154-1	31353-0154-1	31353-0154-1	31353-0154-1
10*	1	Spring assembly	9612-1246-01	9612-1229-01	9612-1229-01	9612-1229-01
11Δ	1	Clip, complete	31353-0793-1	31353-0793-2	31353-0793-2	31353-0793-2
Δ	1	Service kit for actuator	9611-92-0008	9611-92-0009	9611-92-0009	9611-92-0009

*Heavy duty spring not available

Parts marked with Δ are included in the actuator service kits.

Valve Parts

Pos.	Qty	Description	2-inch Part No.	2.5-inch Part No.	3-inch Part No.	4-inch Part No.
Stem Seal						
14Δ	1	Lip seal, EPDM (standard)	31353-0155-1	31353-0155-1	31353-0188-1	31353-0188-1
	1	Lip seal, NBR	31353-0155-4	31353-0155-4	31353-0188-2	31353-0188-2
	1	Lip seal, FPM	31353-0155-3	31353-0155-3	31353-0188-3	31353-0188-3
Clamp						
15	2	Heavy duty clamp	96120-1120-4	96120-1120-4	96120-1120-5	96120-1120-5
Valve Body (industrial)						
16	1	Valve body, upper, 1 port, GC	31353-1032-2	31353-1032-3	31353-1033-4	884-26876
	1	Valve body, upper, 1 port, weld	31353-0054-1	31353-0055-1	31353-0056-1	31353-0058-1
	1	Valve body, upper, 2 ports, GC	884-25795	884-25946		884-29450
	1	Valve body, upper, 2 port, weld	31353-0054-6	31353-0055-6	31353-0056-6	31353-0058-6
17Δ	1	Valve body seal ring, EPDM (standard)	31353-0128-1	31353-0128-1	31353-0205-1	31353-0205-1
	1	Valve body seal ring, NBR	31353-0128-2	31353-0128-2	31353-0205-2	31353-0205-2
	1	Valve body seal ring, FPM	31353-0128-3	31353-0128-3	31353-0205-3	31353-0205-3
	1	Valve body packing, PTFE	31353-0451-1	31353-0451-1	31353-0451-2	31353-0451-2
18	1	Valve body, lower, 2 ports, GC	31353-0030-7	31353-0031-7	31353-0032-7	31353-0066-7
	1	Valve body, lower, 2 ports, weld	31353-0376-1	31353-0380-1	31353-0381-1	31353-0026-1
	1	Valve body, lower, 3 ports, GC	884-25327	31353-0039-7	31353-0040-7	884-26875
	1	Valve body, lower, 3 ports, weld	31353-0376-6	31353-0380-6	31353-0381-6	31353-0026-6
Valve Body (polished)						
16	1	Valve body, upper, 1 port, GC	31353-1030-2	31353-1032-3	31353-1033-4	31353-1032-5
	1	Valve body, upper, 1 port, weld	31353-1106-1	31353-1107-1	31353-1108-1	31353-1109-1
	1	Valve body, upper, 2 port, GC	31353-1033-2	31353-6070-8	884-25209	31353-1033-5
	1	Valve body, upper, 2 port, weld	31353-1106-2	31353-1107-2	31353-1108-2	31353-1109-2
17Δ	1	Valve body seal ring, EPDM (standard)	31353-0128-1	31353-0128-1	31353-0205-1	31353-0205-1
	1	Valve body seal ring, NBR	31353-0128-2	31353-0128-2	31353-0205-2	31353-0205-2
	1	Valve body seal ring, FPM	31353-0128-3	31353-0128-3	31353-0205-3	31353-0205-3
	1	Valve body packing, PTFE	31353-0451-1	31353-0451-1	31353-0451-2	31353-0451-2
18	1	Valve body, lower, 1 port, GC	31353-1030-2	31353-1030-3	31353-1030-4	31353-1030-5
	1	Valve body, lower, 1 port, weld	31353-1101-1	31353-1102-1	31353-1103-1	31353-1104-1
	1	Valve body, lower, 2 port, GC	31353-1031-2	31353-1031-3	31353-1031-4	31353-1031-5
	1	Valve body, lower, 2 port, weld	31353-1101-2	31353-1102-2	31353-1103-2	31353-1104-2

Recommended Spare Parts: Service kit



CSI

CONTACT CSI FOR MORE INFORMATION | CSIDESIGNS.COM | SALES@CSIDESIGNS.COM | 417.831.1411

Valve Parts (continued)

Pos.	Qty.	Description	2-inch Part No.	2.5-inch Part No.	3-inch Part No.	4-inch Part No.
Valve Plug						
20	1	Plug, double, complete, EPDM (standard)	9612-1205-02	9612-1206-02	9612-1207-02	9612-1208-02
	1	Plug, double, complete, NBR	9612-1205-04	9612-1206-04	9612-1207-04	9612-1208-04
	1	Plug, double, complete, FPM	9612-1205-06	9612-1206-06	9612-1207-06	9612-1208-05
b	1	Stem	9612-1209-02	9612-1210-02	9612-1211-03	9612-1211-04
c	1	Seal ring, upper, EPDM (standard)	31353-0321-1	31353-0323-1	31353-0324-1	31353-0325-1
	1	Seal ring, upper, NBR	31353-0321-2	31353-0323-2	31353-0324-2	31353-0325-2
	1	Seal ring, upper, FPM	31353-0321-3	31353-0323-3	31353-0324-3	31353-0325-3
	1	Packing upper, PTFE	31353-1212-1	31353-1216-1	31353-1214-1	31353-1215-1
d	1	Middle piece	9612-1214-01	9612-1215-01	9612-1216-01	9612-1217-02
e	1	Seal ring, lower, EPDM (standard)	31353-0321-1	31353-0322-1	31353-0324-1	31353-0325-1
	1	Seal ring, lower, NBR	31353-0321-2	31353-0322-2	31353-0324-2	31353-0325-2
	1	Seal ring, lower, FPM	31353-0321-3	31353-0322-3	31353-0324-3	31353-0325-3
	1	Packing upper, PTFE	31353-1212-1	31353-1213-1	31353-1214-1	31353-1215-1
f	1	Washer	9612-1234-01	9612-1233-01	9612-1220-01	9612-1232-01
g	1	O-ring, EPDM (standard)	990034-01	990034-01	990034-01	990034-01
	1	O-ring, NBR	223404-21	223404-21	223404-21	223404-21
	1	O-ring, FPM	223404-35	223404-35	223404-35	223404-35
	1	Seal-ring, PTFE	9612-4330-01	9612-4330-01	9612-4330-01	9612-4330-01
h	1	Screw	31353-0362-1	31353-0362-1	31353-0362-1	31353-0362-1
Δ	1	Service kit for valve, EPDM	9611-92-0028	9611-92-0031	9611-92-0034	9611-92-0037
Δ	1	Service kit for valve, NBR	9611-92-0029	9611-92-0032	9611-92-0035	9611-92-0038
Δ	1	Service kit for valve, FPM	9611-92-0030	9611-92-0033	9611-92-0036	9611-92-0039

Parts marked with Δ are included in the valve service kits.

Alternative for Stem Seal

Pos.	Qty.	Description	2-inch Part No.	2.5-inch Part No.	3-inch Part No.	4-inch Part No.
Stem Seal						
14	1	Lip seal kit, EPDM (standard)	9611-92-0078	9611-92-0078	9611-92-0142	9611-92-0142
	1	Lip seal kit, NBR	9611-92-0079	9611-92-0079	9611-92-0143	9611-92-0143
	1	Lip seal kit, FPM	9611-92-0080	9611-92-0080	9611-92-0144	9611-92-0144
a	1	Lip seal, EPDM (standard)	9612-2806-01	9612-2806-01	9612-3088-01	9612-3088-01
	1	Lip seal, NBR	9612-2806-02	9612-2806-02	9612-3088-02	9612-3088-02
	1	Lip seal, FPM	9612-2806-03	9612-2806-03	9612-3088-03	9612-3088-03
b	1	Plate	9612-2805-01	9612-2805-01	9612-3087-01	9612-3087-01
c	1	Seal ring, EPDM (standard)	31353-0128-1	31353-0128-1	31353-0205-1	31353-0205-1
	1	Seal ring, NBR	31353-0128-2	31353-0128-2	31353-0205-2	31353-0205-2
	1	Seal ring, FPM	31353-0128-3	31353-0128-3	31353-0205-3	31353-0205-3
FEP Seal						
14	d	1 Washer	31353-0452-1	31353-0452-1	31353-0452-2	31353-0452-2
	e	1 O-ring FEP/Silicone	9611-99-2909	9611-99-2909	9611-99-2910	9611-99-2910
	f	1 Holder	31353-0453-1	31353-0453-1	31353-0454-1	31353-0454-1
	g	1 Valve body packing	31353-0451-1	31353-0451-1	31353-0451-2	31353-0451-2
•	1	Service kit for alternative stem seal, EPDM	9611-92-0475	9611-92-0479	9611-92-0483	9611-92-0491
•	1	Service kit for alternative stem seal, NBR	9611-92-0476	9611-92-0480	9611-92-0484	9611-92-0492
•	1	Service kit for alternative stem seal, FPM	9611-92-0477	9611-92-0481	9611-92-0485	9611-92-0493
•	1	Service kit for alternative stem seal, FEP	9611-92-0478	9611-92-0482	9611-92-0486	9611-92-0494

Parts marked with • are included in the for alternative stem seal service kits.

Valve Body Combinations:

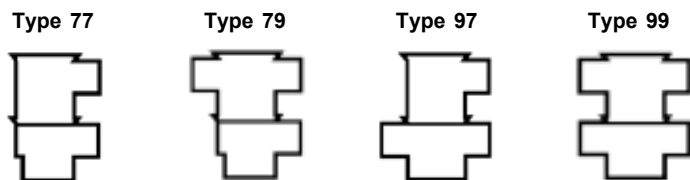

Recommended Spare Parts: Service kit

Alfa Laval

8201 104th Street
Pleasant Prairie, WI 53158-0909
Telephone: 800-558-2060
Fax: 262-947-4724
www.us.flow.alfalaval.com



CSI

CONTACT CSI FOR MORE INFORMATION | CSIDESIGNS.COM | SALES@CSIDESIGNS.COM | 417.831.1411