

Alfa Laval OptiLobe Rotary Lobe Pump

Competitive Reliability

Application

The OptiLobe range of rotary lobe pumps combines cost-effective simplicity and easy maintenance with Alfa Laval quality and reliability. The OptiLobe range has been developed for general applications within the Dairy, Beverage, Food, home and personal care industries.

The OptiLobe pump range has been certified by EHEDG (European Hygienic Equipment Design Group) as fully CIP cleanable to their protocol, and therefore is ideally suited for applications where cleanability is paramount.

Also the OptiLobe pump range conforms to 3A Hygienic Standard and all media contacting components are FDA compliant.

The pump features the "EasyFit" front loading seal which allows quick and easy inspection or replacement without the need for pipework disassembly.

The OptiLobe pump range is compact, efficient and capable of flow rates up to 77 m³/h and pressures up to 8 bar.



TECHNICAL DATA

Standard materials

Pump head W. 1.4404 (316L)
 Product wetted elastomers: . . . EPDM or FPM
 Other elastomers: FPM
 Shaft seal Single, Carbon/Stainless Steel
 Shafts Duplex stainless steel
 Gear canister Stainless steel
 Base plate Stainless steel
 Coupling guard Stainless steel

Motors

Gear motor, 4 poles, to IEC metric standard, 50/60 Hz, suitable for frequency conversion, IP55, insulation class F.

Warranty

Extended 3-years warranty on Alfa Laval OS pumps. The warranty covers all non-wear parts on the condition that genuine Alfa Laval Spare Parts are used.

Shaft seals

EasyFit single and single flush available. All options are fully front loading and interchangeable.

Flush connection, OptiLobe 12-43: . . . Rp 1/8"
 Flush connection, OptiLobe 52-53: . . . Rp 1/4"
 Max flush pressure: 0.5 bar
 Flush flow rate: 30 l/h

Pressure

Max discharge pressure 8 bar

Temperature

Max temperature 130°C

Operating data

	Displacement			Inlet/Outlet		Diff. Pressure		Max Speed
	Litres/ rev	Imp gall/ 100 rev	US gall/ 100 rev	mm	inch	bar	psi	rpm
OptiLobe 12	0.06	1.23	1.48	25	1	8	115	1000
OptiLobe 13	0.10	2.18	2.61	40	1.5	8	115	1000
OptiLobe 22	0.17	3.74	4.49	40	1.5	8	115	1000
OptiLobe 23	0.21	4.62	5.55	40	1.5	8	115	1000
OptiLobe 32	0.32	7.04	8.45	50	2	8	115	1000
OptiLobe 33	0.40	8.80	10.57	50	2	8	115	1000
OptiLobe 42	0.64	14.08	16.91	65	2.5	8	115	1000
OptiLobe 43	0.82	18.04	21.66	80	3	8	115	1000
OptiLobe 52	1.17	25.74	30.89	80	3	8	115	750
OptiLobe 53	1.72	37.84	45.41	100	4	8	115	750

Dimensions

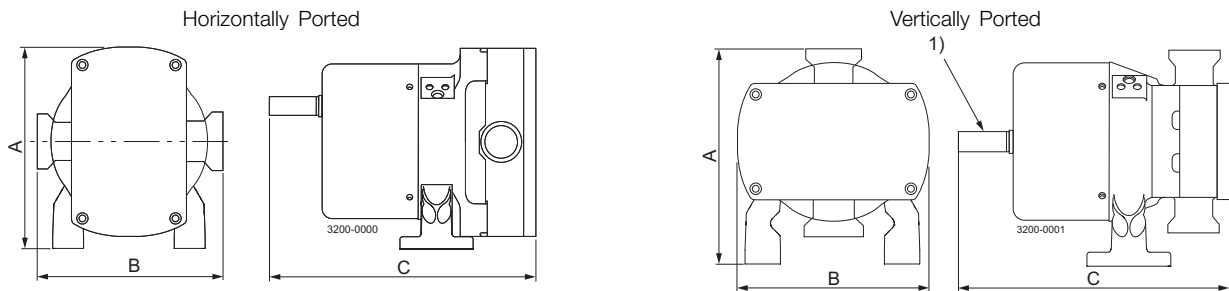

	Horizontally Ported			Vertically Ported			Weight
	A mm	B mm	C mm	A mm	B mm	C mm	(bare shaft) Kg
OptiLobe 12	171	172	228	181	152	228	11.5
OptiLobe 13	171	172	241	181	152	241	12.5
OptiLobe 22	216	192	277	216	191	277	20.5
OptiLobe 23	216	192	286	216	191	286	21.5
OptiLobe 32	251	240	304	256	230	304	33.5
OptiLobe 33	251	240	316	256	230	316	34.5
OptiLobe 42	294	260	371	289	270	371	60
OptiLobe 43	294	276	387	297	270	387	63
OptiLobe 52	366	324	480	358	340	480	116
OptiLobe 53	366	324	508	358	340	508	128

Options

- A. Single mechanical shaft seal with flush.
- B. Silicon Carbide/Carbon seal faces.
- C. Silicon Carbide/Silicon Carbide seal faces.
- D. Product wetted elastomers in FPM.
- E. Heating and cooling front cover.
- F. Horizontal or vertical porting.
- G. Stainless steel shroud covering coupling and motor.
- H. Baseplate fitted with adjustable stainless steel ball feet.

Pump sizing

In order to correctly size a rotary lobe pump some essential information is required. Provision of this information listed below enables our Technical Support personnel to obtain the optimum pump selection.

Product/Fluid Data

- Fluid to be pumped
- Viscosity
- Pumping temperature, minimum, normal and maximum
- Cleaning in Place temperature(s), minimum, normal and maximum

Performance Data

- Flow rate, minimum, normal and maximum
- Discharge head/pressure (closest to pump outlet)
- Suction condition



Alfa Laval reserves the right to change specifications without prior notification.

How to contact Alfa Laval

Contact details for all countries are continually updated on our website. Please visit www.alfalaval.com to access the information direct.



CSI

CONTACT CSI FOR MORE INFORMATION | CSIDESIGNS.COM | SALES@CSIDESIGNS.COM | 417.831.1411