

STANDARD
Pump, Inc.

PURE PUMP
Series



Sanitary Drum Transfer Pumps

SP-8600 & SP-8700

3 YEAR
WARRANTY

P/N: 8600-8700-0613

SP-8600 / SP-8700 Series



Hygienic drum pump solutions for transferring sanitary products.

Standard Pump is the global leader in Hygienic Drum Pump solutions and offers a broad range of pumps to meet the stringent safety requirements of the sanitary process industry. Standard Pumps' SP-8600 & SP-8700 Series sanitary centrifugal pumps offer the ideal solution for transferring juices, concentrates, beer, wine, and cosmetic fragrances from barrels, kettles and Tote® tanks. The SP-8600 & SP-8700 Series pumps incorporate a proven hygienic design and FDA Compliant materials of construction (CFR 21.177) insuring a safe, robust and efficient sanitary solution.



Features

- FDA Compliant Materials of Construction
- Hygienic Design
- Easy to Clean
- Tri-clamp® Fittings
- Light Weight & Portable
- Variable Speed Electric & Air Motors
- Runs Dry

Common Applications

- Juices
- Concentrates
- Personal Care Products
- Pharmaceuticals
- Beer
- Wine
- Cosmetic Fragrances

Technical Specifications

Model Number:	SP-8600-39, SP-8600-47 SP-8700-39, SP-8700-47
Immersion Length:	39" (1000 mm) Drums 47" (1200 mm) Tote® Tanks and Kettles
Wetted Components:	SS316L, PTFE & Buna
Motor Drive:	SP-280P, SP-ENC, SP-A1, SP-A2, SP-400 Series
Discharge Size:	1.5" (38 mm) Tri-clamp® Connection
Maximum Viscosity:	1,000 cps (mPAS)*
Maximum Discharge Pressure:	43 psi (2,9 bar)
Maximum Flow Rate:	35 GPM (132 LPM)
Pump Shipping Weight:	
PN: SP-8600-39, SP-8700-39	12 lbs (5,5 kg)
PN: SP-8600-47, SP-8700-47	14 lbs (6,4 kg)
Maximum Temperature:	175° F (80° C)

Flow Curves

High Volume Pumps (SP-8600 Series):

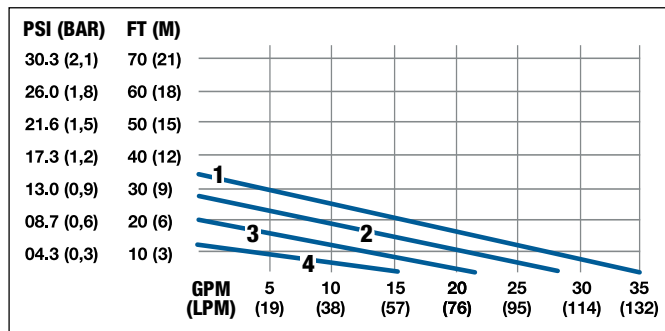

1 SP-280P, SP-ENC	2 SP-420EX, SP-A2	3 SP-A1	4 SP-410EX
-------------------	-------------------	---------	------------

High Pressure Pumps (SP-8700 Series):

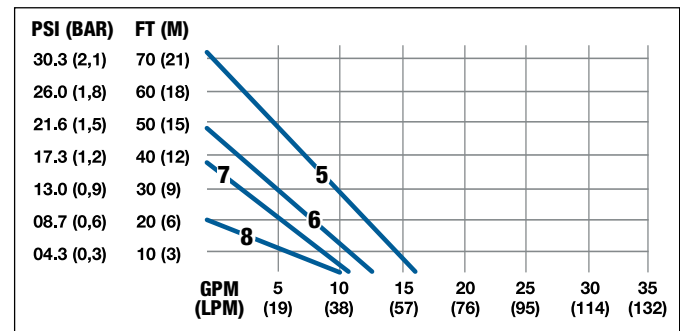

5 SP-280P, SP-ENC	6 SP-420EX, S SP-A2	7 SP-A1	8 SP-410EX
-------------------	---------------------	---------	------------

Note: Pump is constructed with FDA compliant materials; however, the pump does not have FDA certification.
*Pump is intended for intermittent use when operating at maximum viscosity.

SP-8600 / SP-8700 Series

Pump Component Features

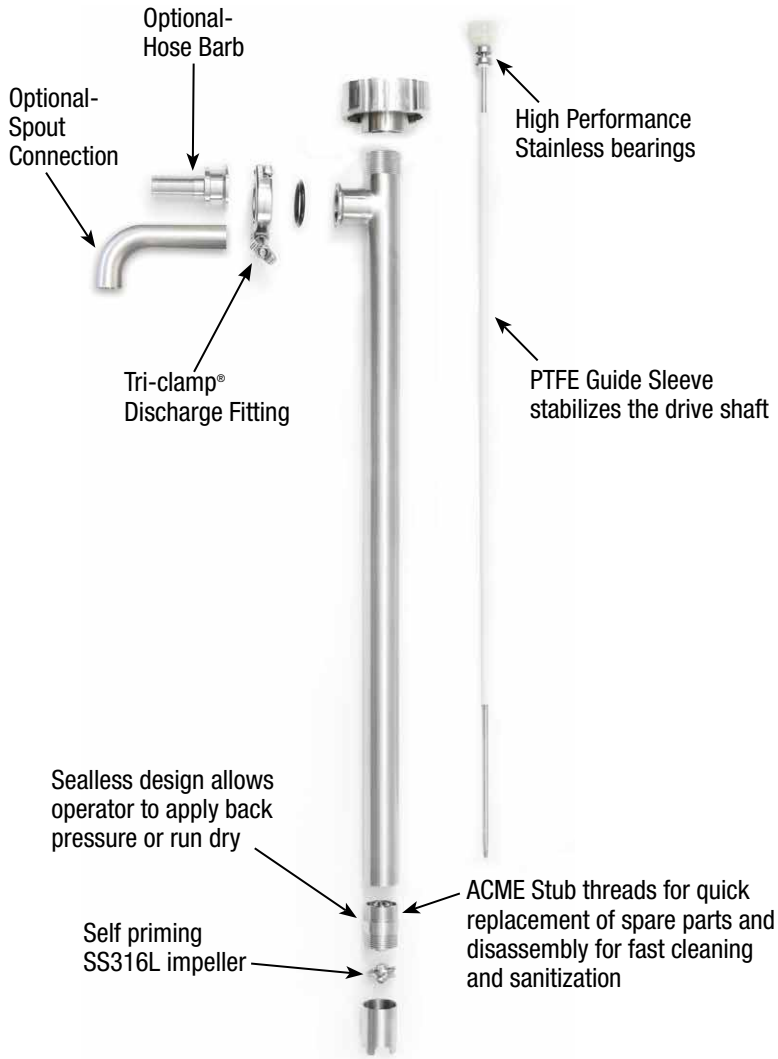

Dimensions

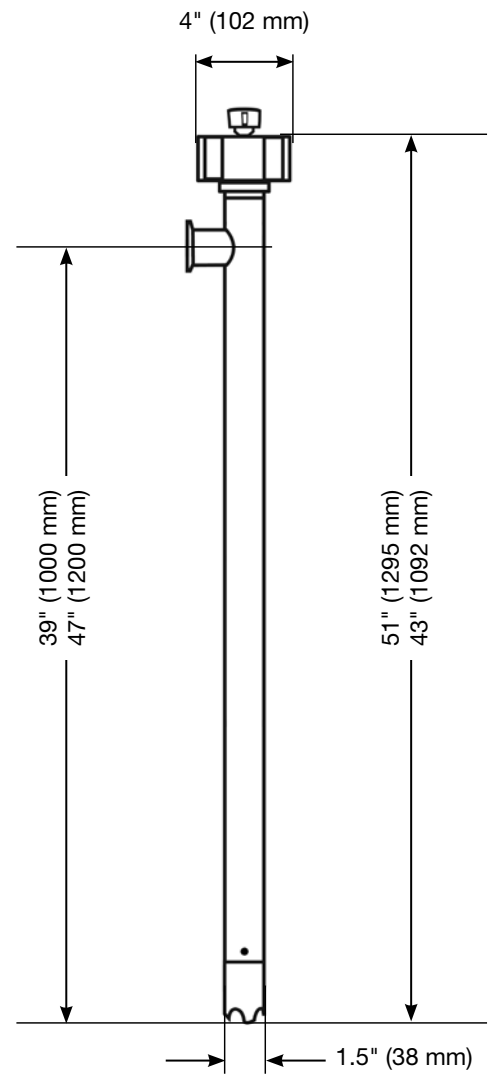

Motor Drives



Accessories



PURE PUMP Series



Additional Sanitary Products Available:

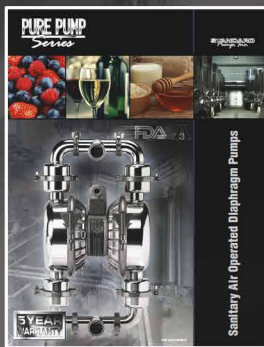

Air Operated
Diaphragm Pumps

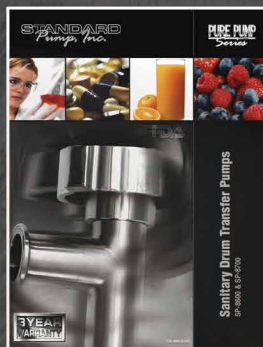

FDA Compliant Drum
Pumps

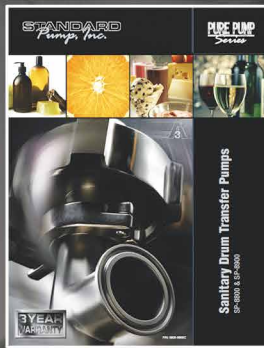

3A Drum Pumps

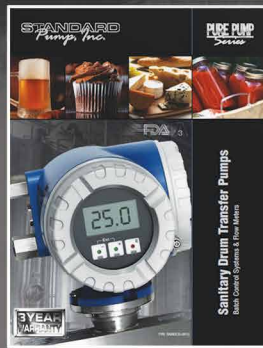

Batch Control
Systems

STANDARD
Pump, Inc.

Distributed By:



CSI 417.831.1411
csidesigns.com