

STANDARD
Pump, Inc.



CSI
417.831.1411
csidesigns.com

PURE PUMP
Series



3 YEAR
WARRANTY

Sanitary Drum Transfer Pumps

SP-8800 & SP-8900

P/N: 8800-8900-0613

SP-8800 / SP-8900 Series



Hygienic design enables operators to disassemble, clean and sanitize.

Standard Pump is the global leader in Hygienic Drum Pump solutions and offers a broad range of pumps to meet the stringent safety requirements of the sanitary process industry. Standard's SP-8800 & SP-8900 Series sanitary centrifugal pumps offer the ideal solution for transferring dairy products, pharmaceuticals, juices, concentrates, beer, wine, and cosmetic fragrances from barrels, kettles and Tote® tanks. The SP-8800 & SP-8900 Series pumps are 3A certified and incorporate a hygienic design that enables operators to quickly disassemble and sanitize.



Features

- 3A Certified (TPV)
- Hygienic Design
- Easy to Clean
- Tri-clamp® Fittings
- Light Weight & Portable
- Variable Speed Electric & Air Motors
- Runs Dry

Common Applications

- Juices
- Concentrates
- Personal Care Products
- Pharmaceuticals
- Beer
- Wine
- Cosmetic Fragrances

Technical Specifications

Model Number:	SP-8800-39, SP-8800-47 SP-8900-39, SP-8900-47
Immersion Length:	39" (1000 mm) Drums 47" (1200 mm) Tote® Tanks and Kettles
Wetted Components:	SS316L, PTFE & Buna
Motor Drive:	SP-ENC, SP-A1, SP-A2, SP-400 Series
Discharge Size:	1.5" (38 mm) Tri-clamp® Connection
Maximum Viscosity:	1,000 cps (mPAS)*
Maximum Discharge Pressure:	40 psi (2,8 bar)
Maximum Flow Rate:	35 GPM (132 LPM)
Pump Shipping Weight:	
PN: SP-8800-39, SP-8900-39	12 lbs (5,5 kg)
PN: SP-8800-47, SP-8900-47	14 lbs (6,4 kg)
Maximum Temperature:	175° F (80° C)
Pump Finish:	32 Ra

Flow Curves

High Volume Pumps (SP-8800 Series):

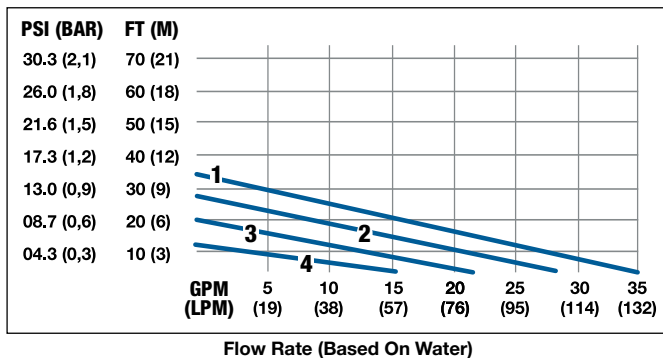

1 SP-ENC	2 SP-420EX, SP-A2	3 SP-A1	4 SP-410EX
----------	-------------------	---------	------------

High Pressure Pumps (SP-8900 Series):

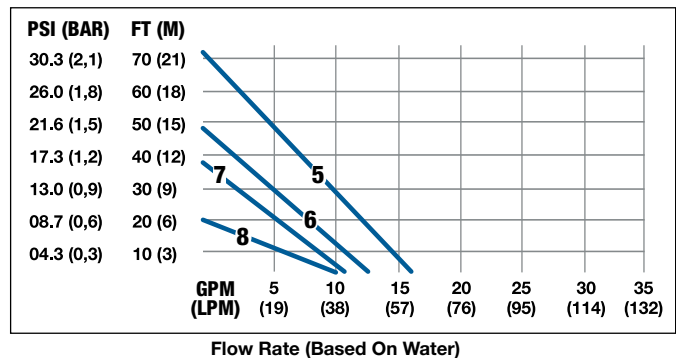

5 SP-ENC	6 SP-420EX, SP-A2	7 SP-A1	8 SP-410EX
----------	-------------------	---------	------------

Note: Pump is constructed with FDA compliant materials; however, the pump does not have FDA certification.
*Pump is intended for intermittent use when operating at maximum viscosity.

SP-8800 / SP-8900 Series

Pump Component Features

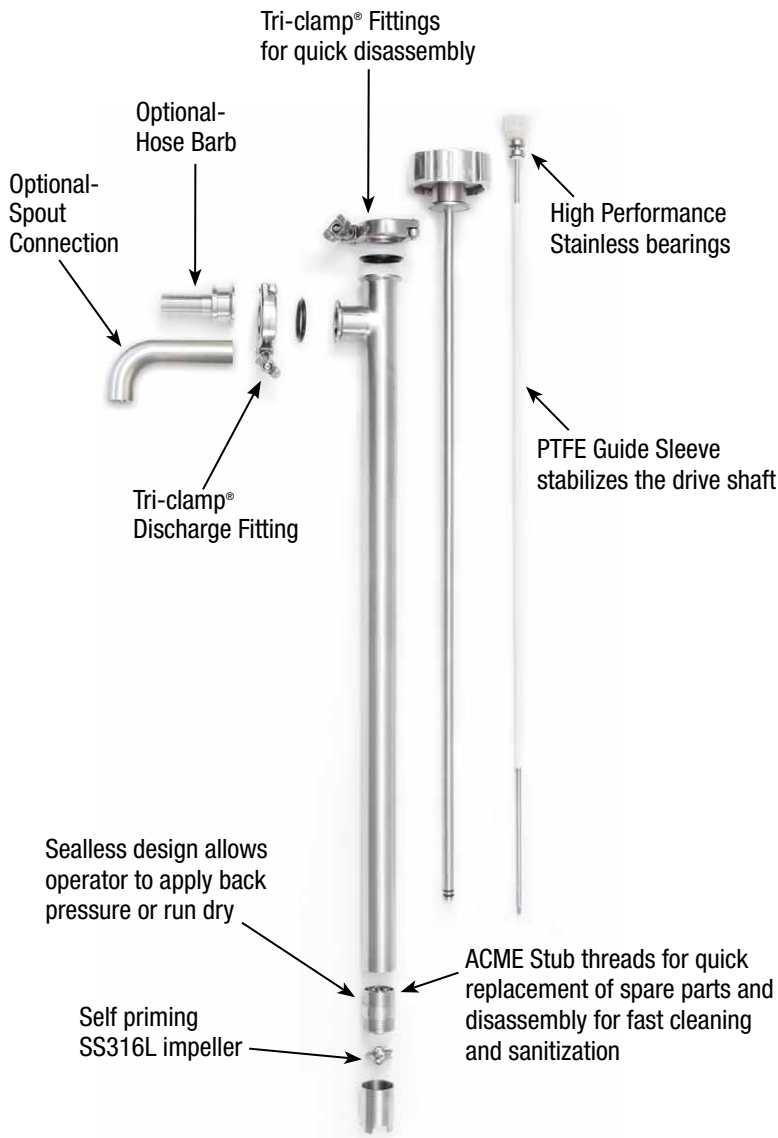

Dimensions

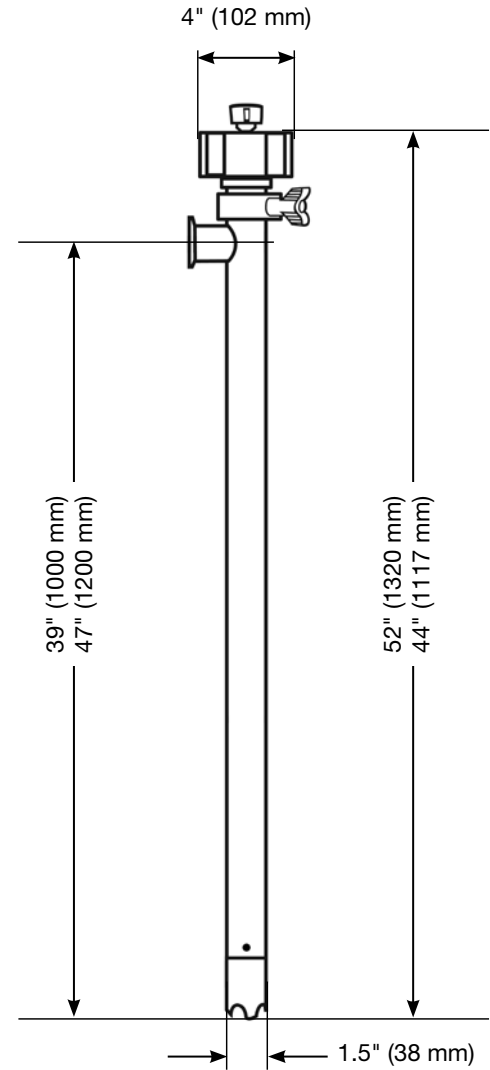

Motor Drives



Accessories



PURE PUMP Series



Additional Sanitary Products Available:

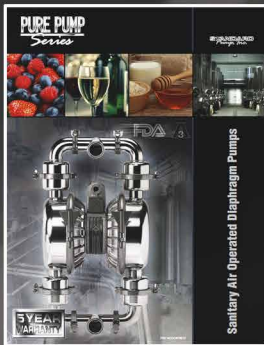

Air Operated
Diaphragm Pumps

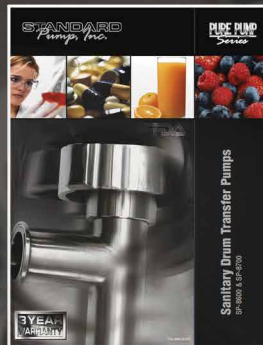

FDA Compliant Drum
Pumps

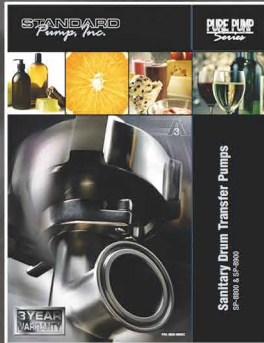

3A Drum Pumps

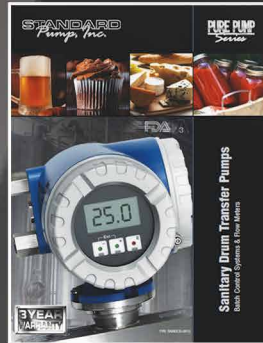

Batch Control
Systems

STANDARD
Pump, Inc.

Distributed By:



CSI 417.831.1411
csidesigns.com